



FlyOut Pro

Version 1.2

## User Manual



Thank you for choosing "FlyOut pro"! This user manual has been designed to help you make the most of our software and efficiently work with the PlugIn.

Please read this manual carefully to ensure a smooth and successful conversion process. If you have any further questions, do not hesitate to contact our support team.

We wish you success and enjoyment in using "FlyOut pro"!

Table of contents

1. Quick Guide
2. Overview of the User Interface (UI)
3. Manual

## Quick Guide

1. Start plugin



2. Select the desired presets by clicking on the selection buttons.  
Presets for all attributes can be selected here.

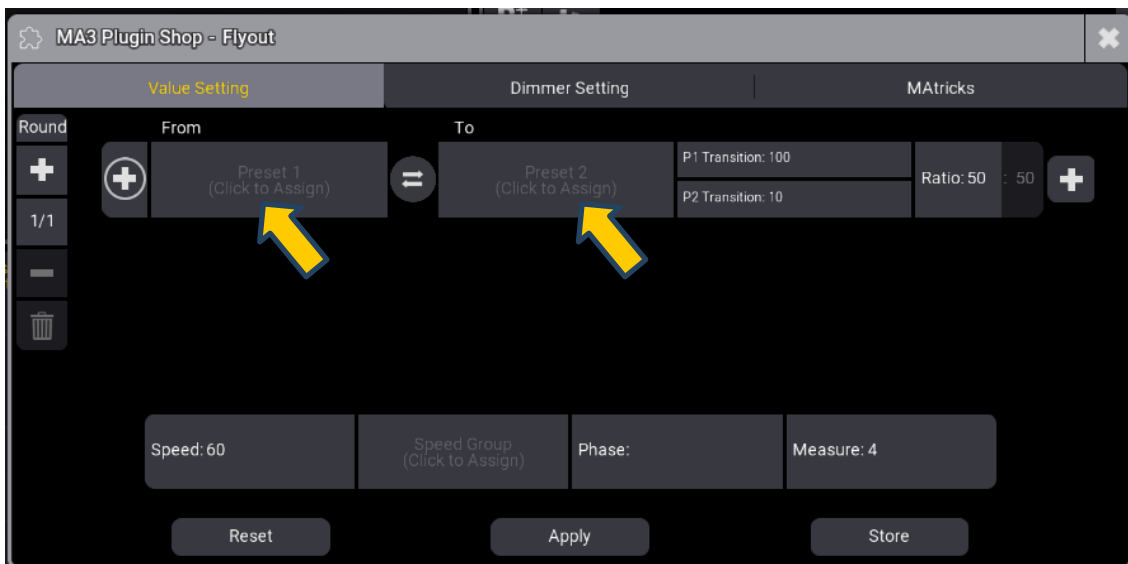

3. Select your fixture if you have not already done so.

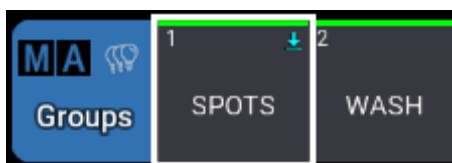

4. After selecting the presets, click Apply to start the FlyOut.

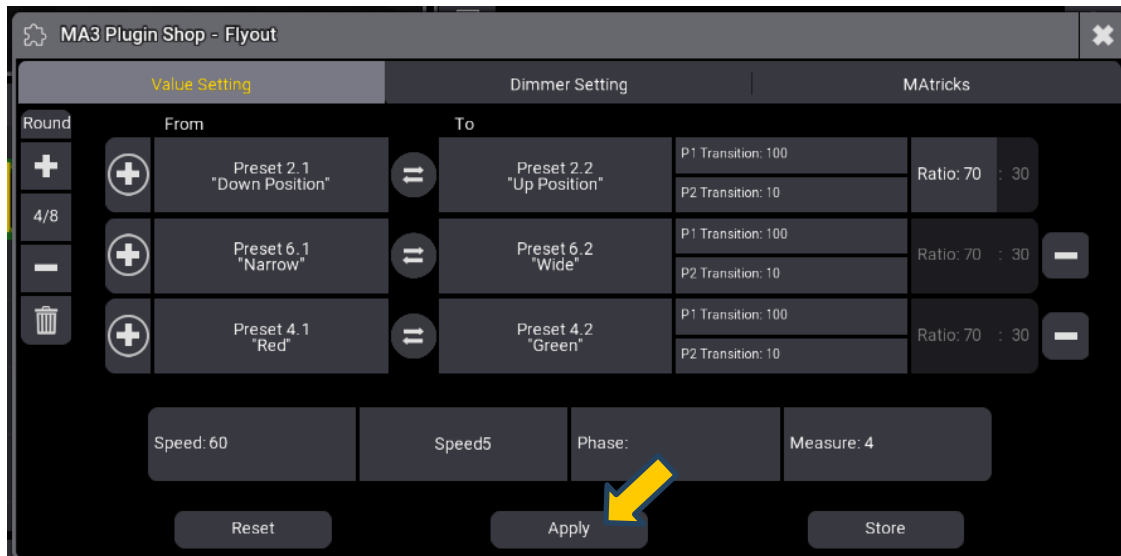

5. You can now do your MATricks settings.



In the "Value Settings", "Dimmer Settings" and "MATricks" areas, any fine tuning can now be carried out, which can then be executed with Apply.

The phaser settings are located in the programmer as usual and can be saved as presets or directly in a sequence.

## Overview of the User Interface (UI)

The UI provides a structured and clear way to configure and adjust various aspects of the system. By dividing it into the three main sections "Value Settings," "Dimmer Settings," and "MAtricks," users can efficiently and effectively make the desired settings.

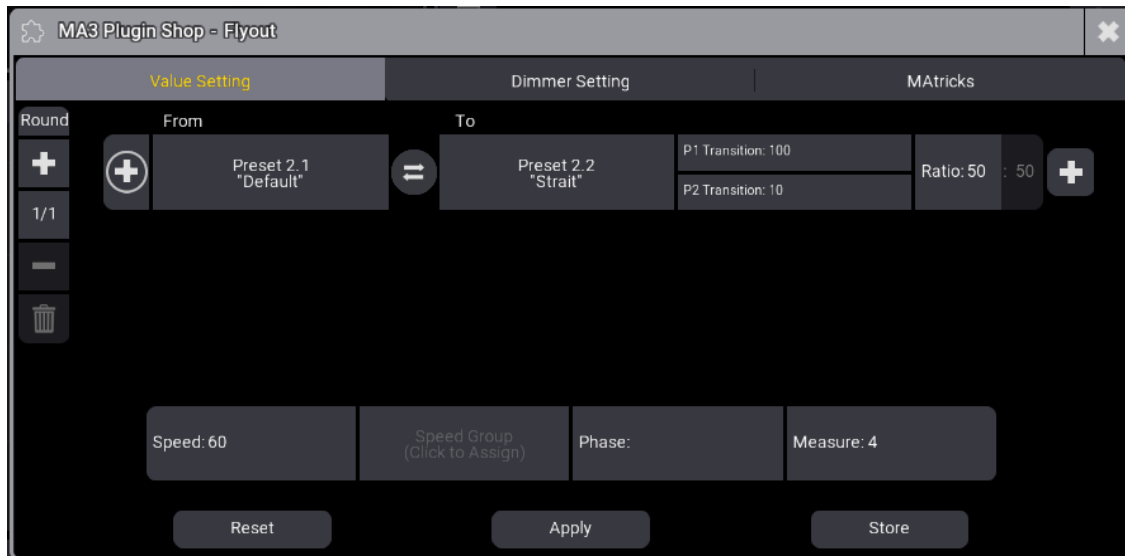

### Value Settings

In this section, all settings related to the attributes of the FlyOut are configured. Users can set specific values and parameters for the FlyOut, such as position, size, color, and other attributes.

### Dimmer Settings

This section allows users to adjust brightness values and the dimmer curve. Users can control the light intensity and the way brightness is adjusted here. This includes settings for maximum and minimum brightness, as well as the shape of the dimmer curve (linear, logarithmic, etc.).

### MAtricks

In this section, selection and grouping settings are configured. Users can define how different elements are selected and grouped. This includes setting Blocks, Groups, and Wings for more efficient management and control of multiple elements simultaneously and influence the look of the FlyOut.

## Preset Selection

In this section, attribute settings are configured. This means that presets can be selected and transition settings adjusted. For a FlyOut sequence, up to three preset slots are available x that can be executed simultaneously. Each slot has individual transition setting options.

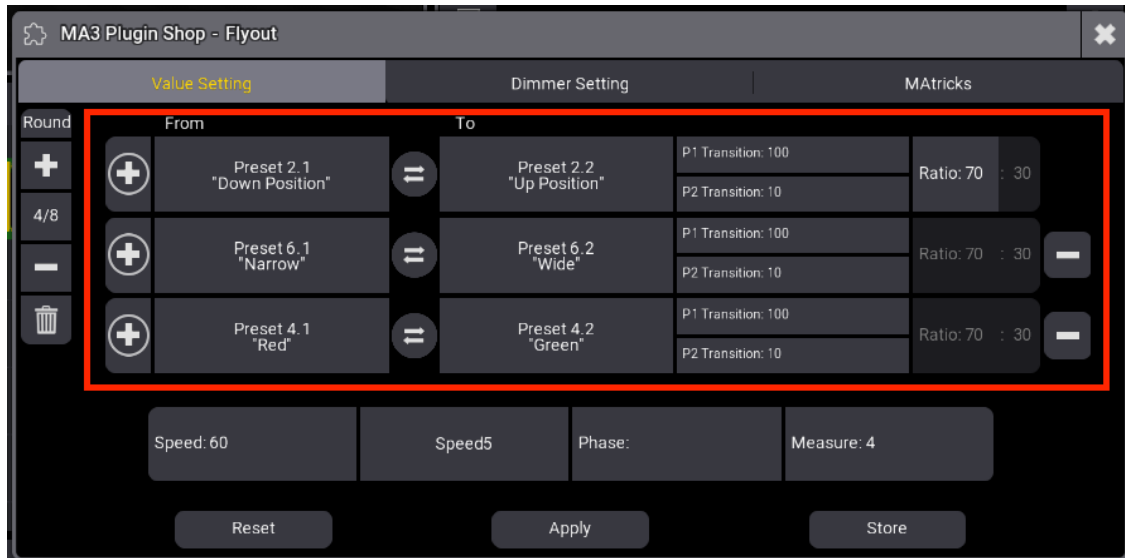

## Phaser Overall Settings

In this section, you can set the speed of the phaser or assign a "Speed Master" to the phaser. Phase settings can be adjusted here (though we recommend doing this within the MATricks). Additionally, measures can be managed here. Note that measures are set per "FlyOut Round." When using multiple rounds, the number of measures increases accordingly.

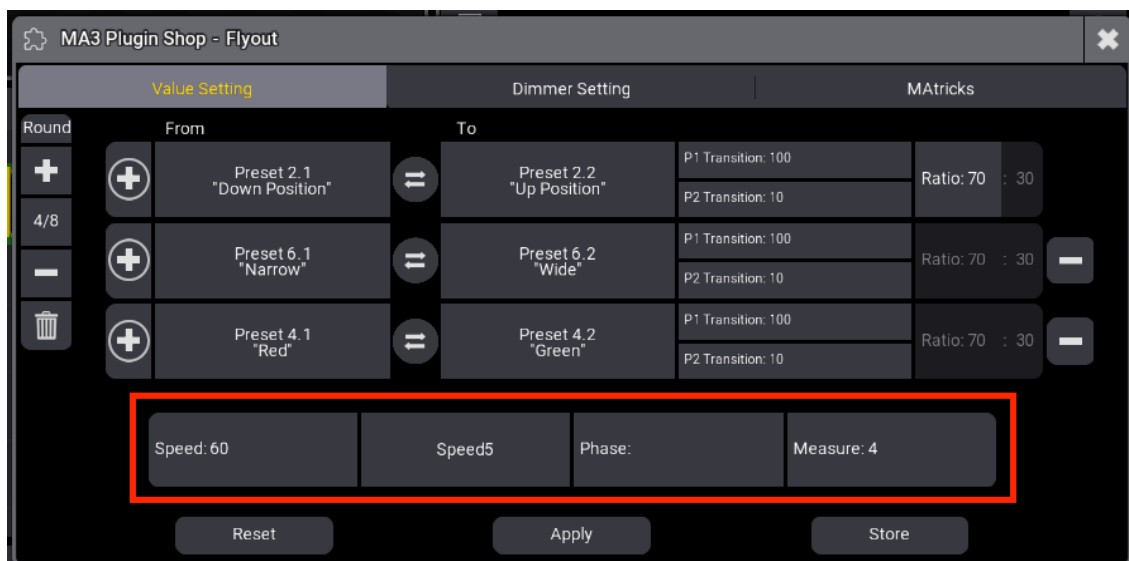

## Rounds

A FlyOut run through is referred to as a "round." It is possible to program up to 8 different rounds that run sequentially before the FlyOut phaser starts again from the beginning. All FlyOut settings, such as attributes, transitions, width, and dimmer settings, can be individually adjusted for each round.

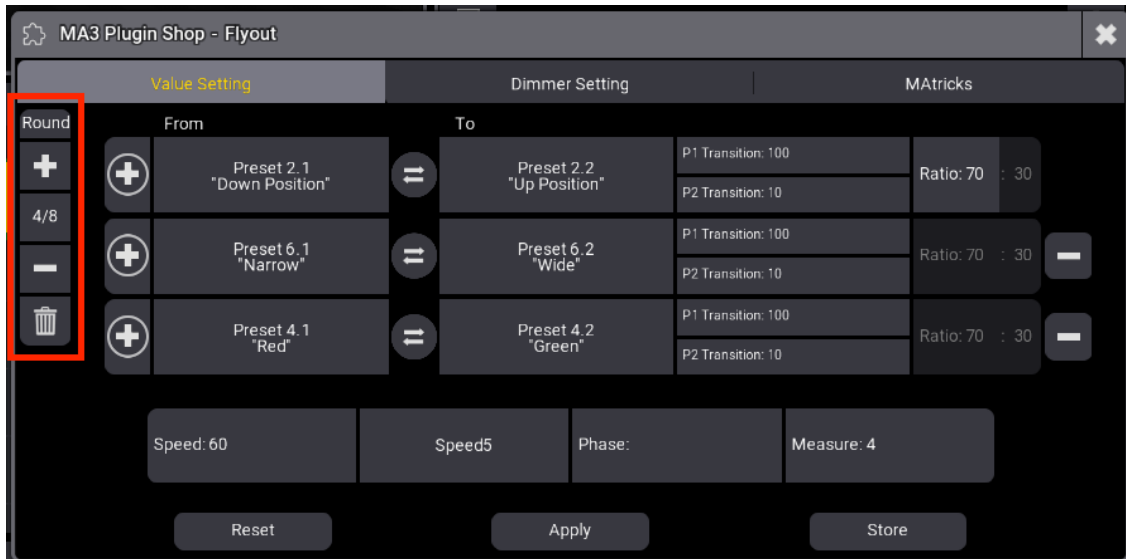

## Execution Elements

Reset: Resets all parameters to their default settings.

Apply: Initiates the Phaser process based on the configured parameters.

Store: Allows direct storing of the current Phaser state into a preset or sequence.

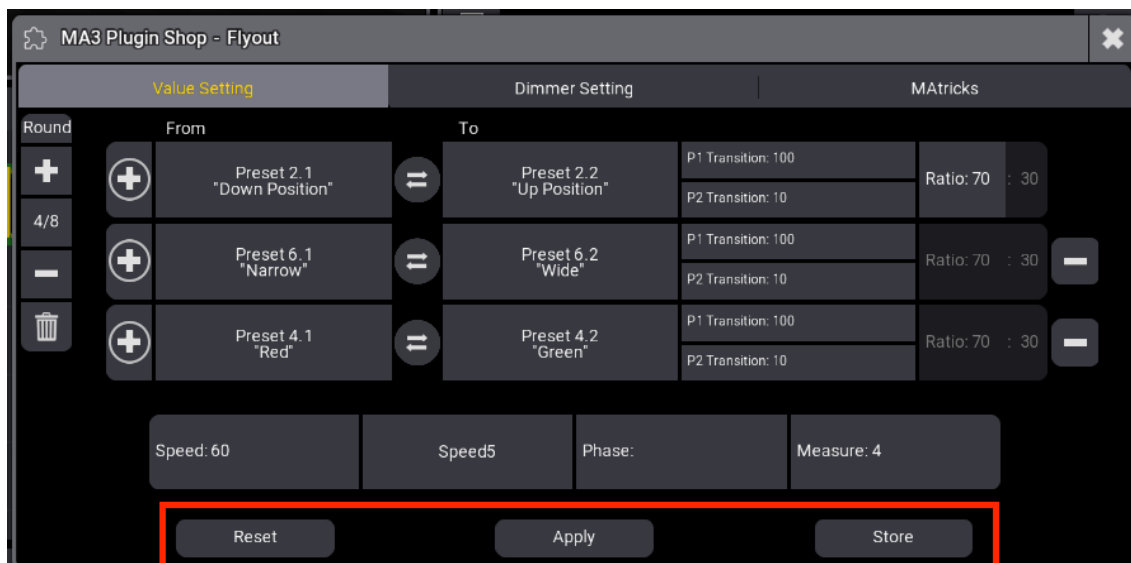

## Dimmer Settings

In this section, dimmer values can be adjusted for the forward and return phases per round. Preset usage is also supported.

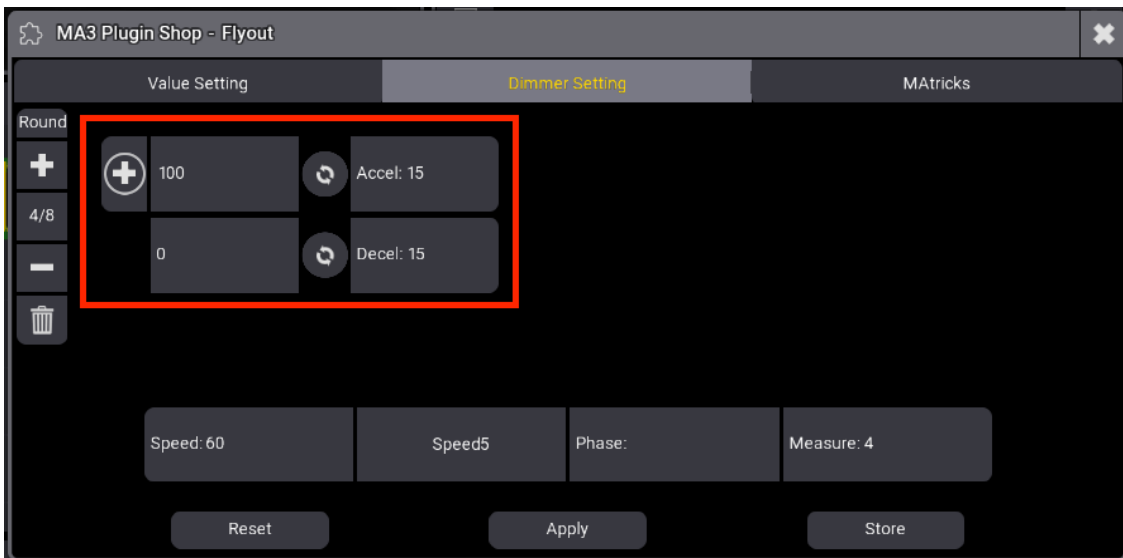

## MATricks Settings

All desired MATricks settings can be directly adjusted within the plugin. This allows for making multiple adjustments until achieving the desired look.



## Add an Preset

There are several ways to add a preset. To do this, click on the preset area and select your desired preset from the list in the drop-down menu.

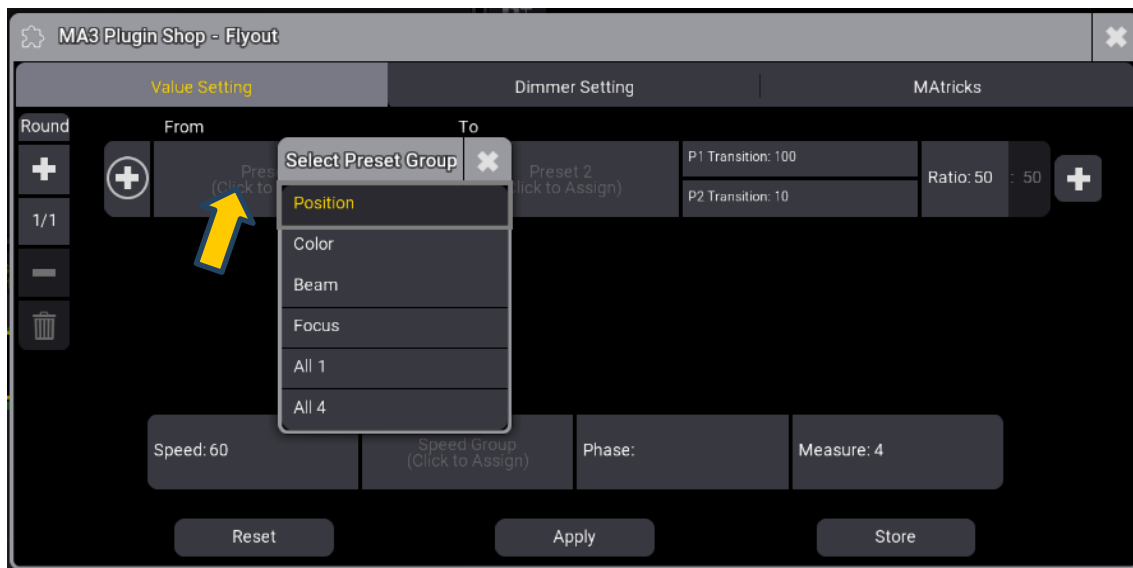

## Select a preset directly from the preset pool.

To select a preset directly from a preset pool, please proceed as follows.

1. click on the cross in the circle next to the preset slot.

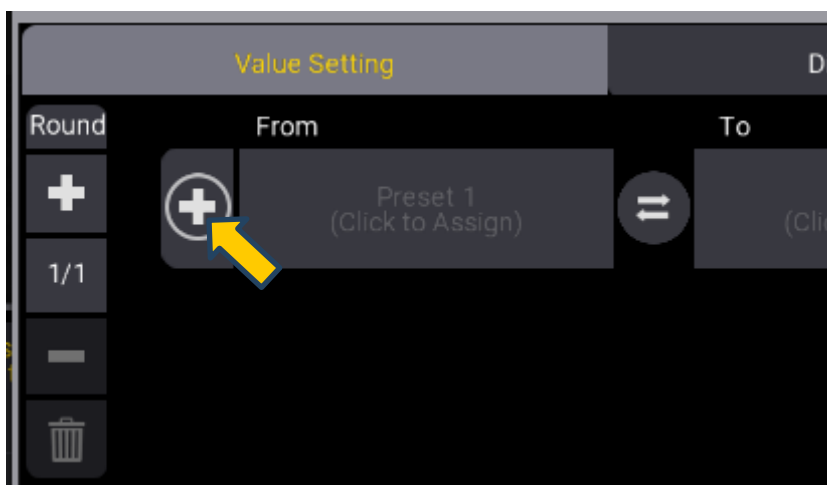



The plugin will close and you can now click on a pool element to select two presets for your FlyOut effect. Please note that you must select your presets immediately after closing the plugin. It is not possible to open a new view or a preset pool beforehand.

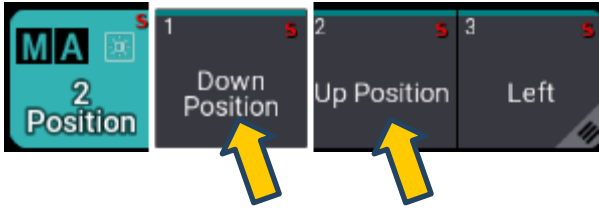

After you have selected the second preset, the plugin opens again and your presets are added to the preset slot

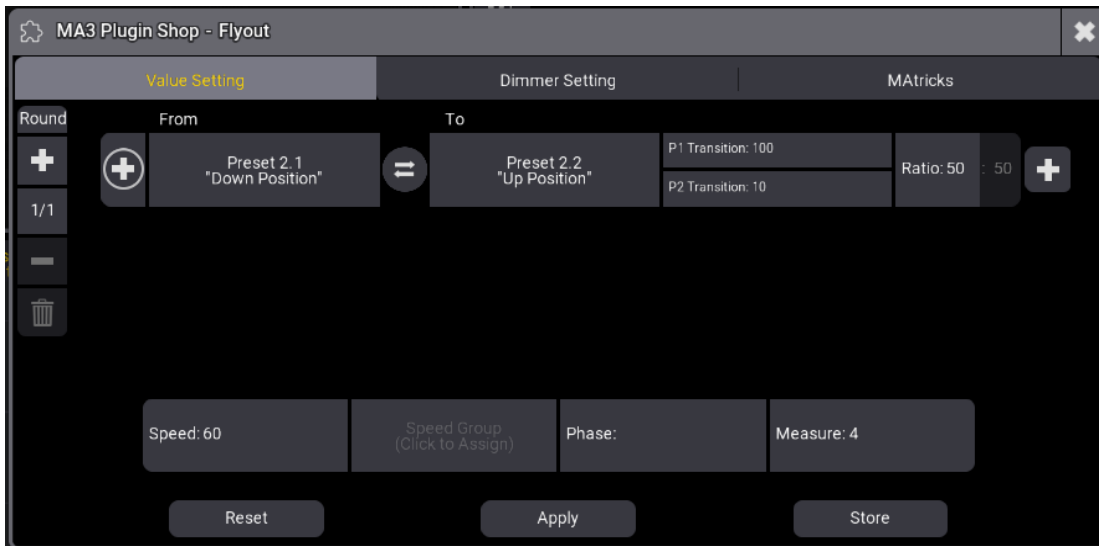

## Multiple presets

It is possible to select up to 3 presets for a FlyOut. To create an additional preset slot, click on the plus symbol to the right of the preset slot.

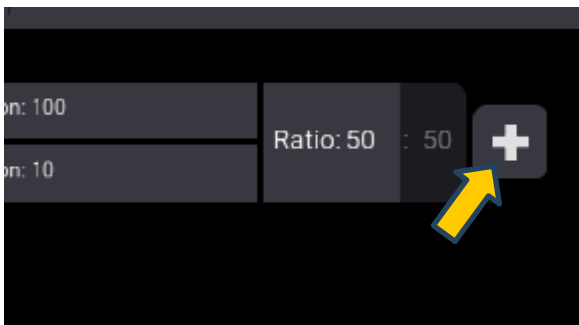

When adding presets, please note that "All presets" can only be used in slot 1.

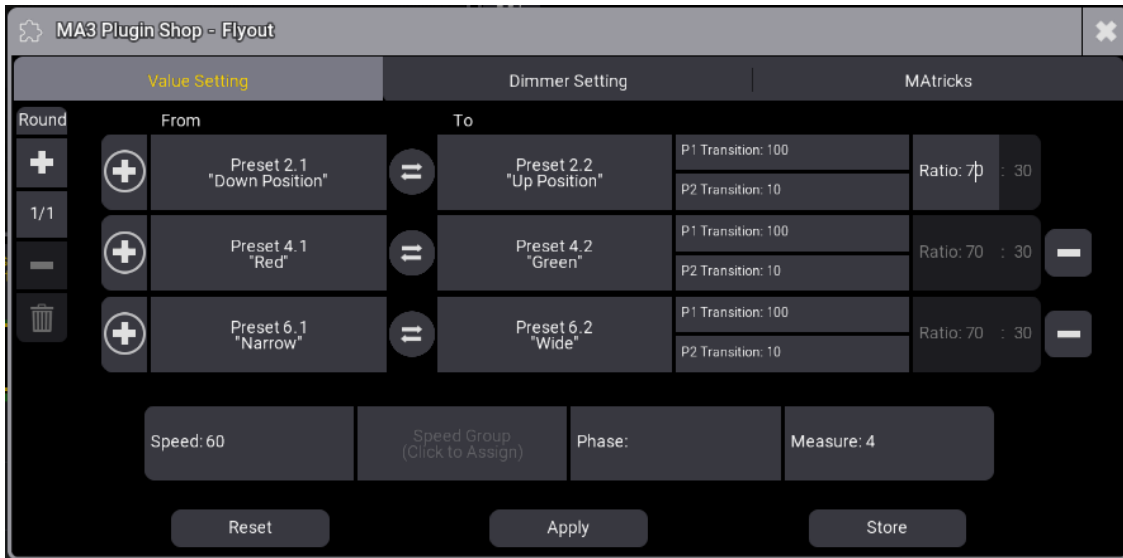

A separate transition value can be entered for each preset.  
The input ratio regulates the ratio of flow and return.

## Start flyout

Click on the Apply button to transfer the data to the phaser editor.

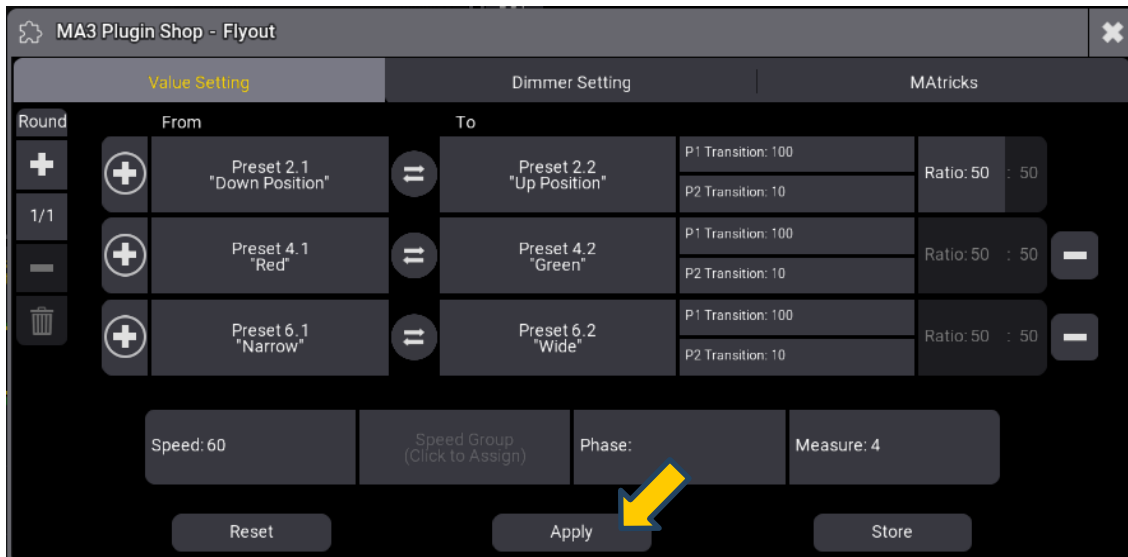

## Phaser overall settings

A phaser speed can be entered directly. The default value is 60 bpm.

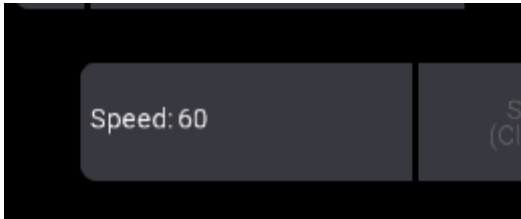

Click on it to open a drop-down menu in which you can directly set a Speed Master for the flyout phaser.

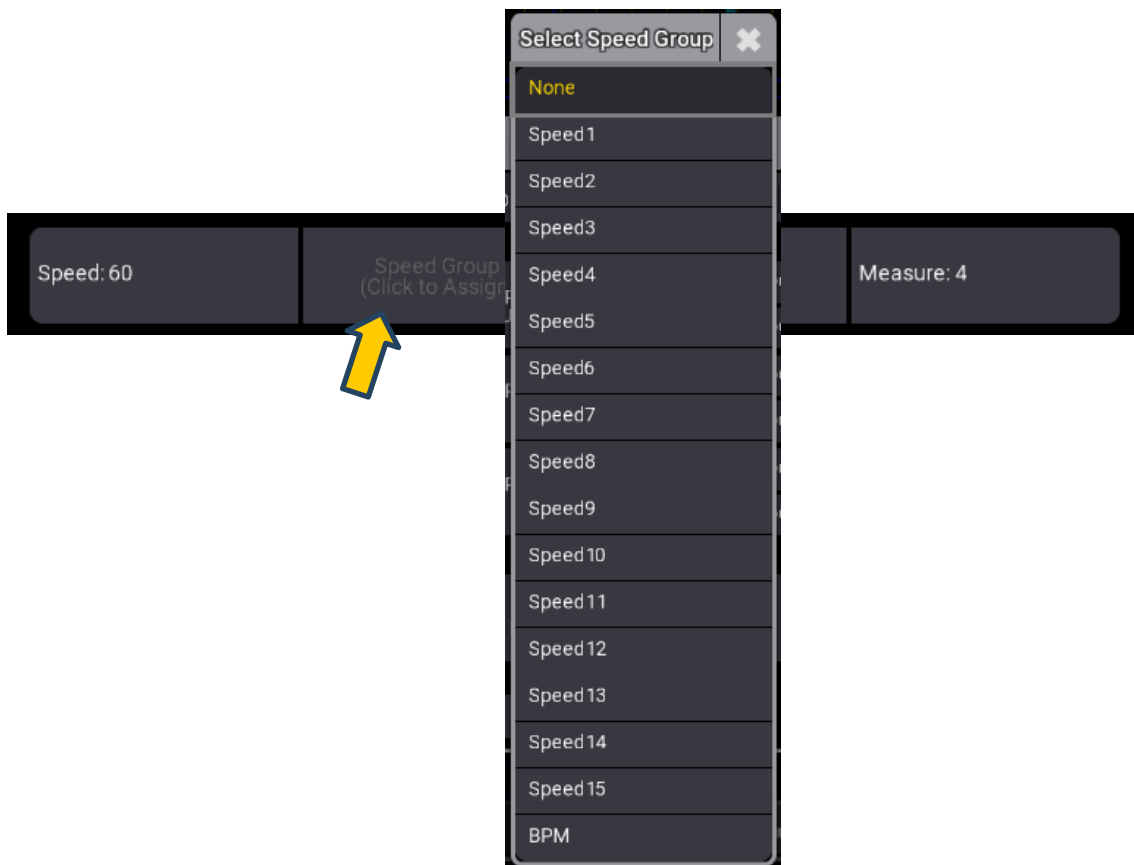

A phase value for the phaser can also be set directly here. Our recommendation is to do this later with the MATricks in order to achieve the greatest possible flexibility

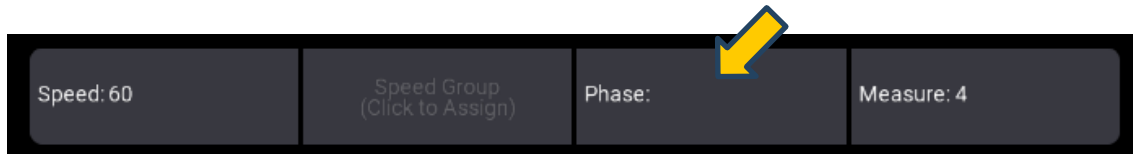

The measured value entered is valid for one FlyOut run.



## Dimmer Settings

The intensity values are set in this area. The default value is 100% for the forward run and 0 percent intensity for the return run of the FlyOut.

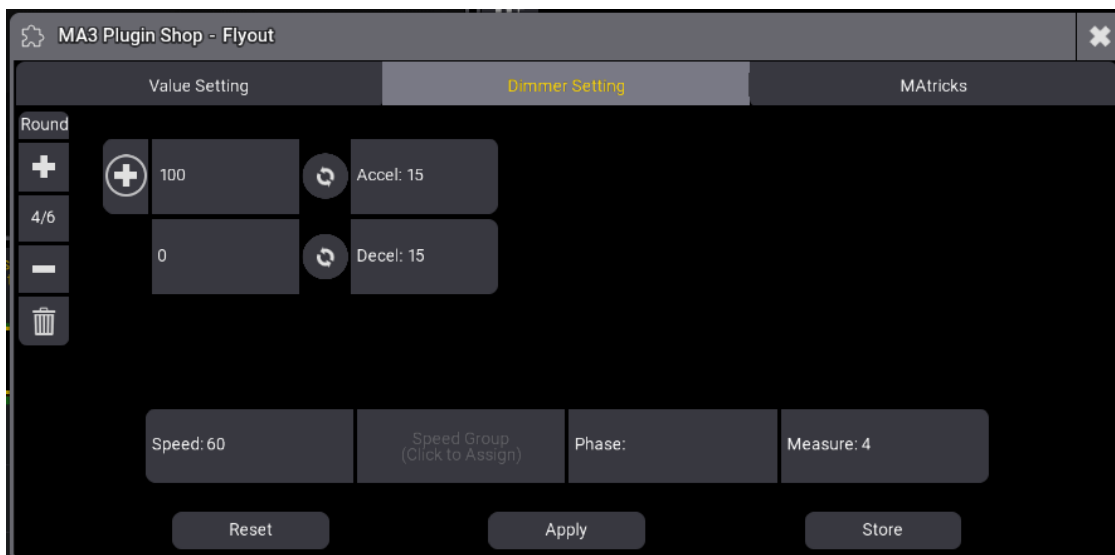

By clicking on the stock exchange symbol, the value can be entered via a preset. The same selection options apply here as for the presets. Selection via a drop-down menu or direct selection via the corresponding dimmer preset pool.



The values for "Accel" and "Decel" influence the transition and the dimmer curve when the fly-out phaser is in forward motion.

## Matricks settings

Use the MAtricks settings to give your flyout phaser an individual sorting.



## Rounds

A run of the FlyOut with forward and reverse is referred to as a "round".

It is possible to create up to 8 different rounds until the phaser starts again at the beginning with round 1.

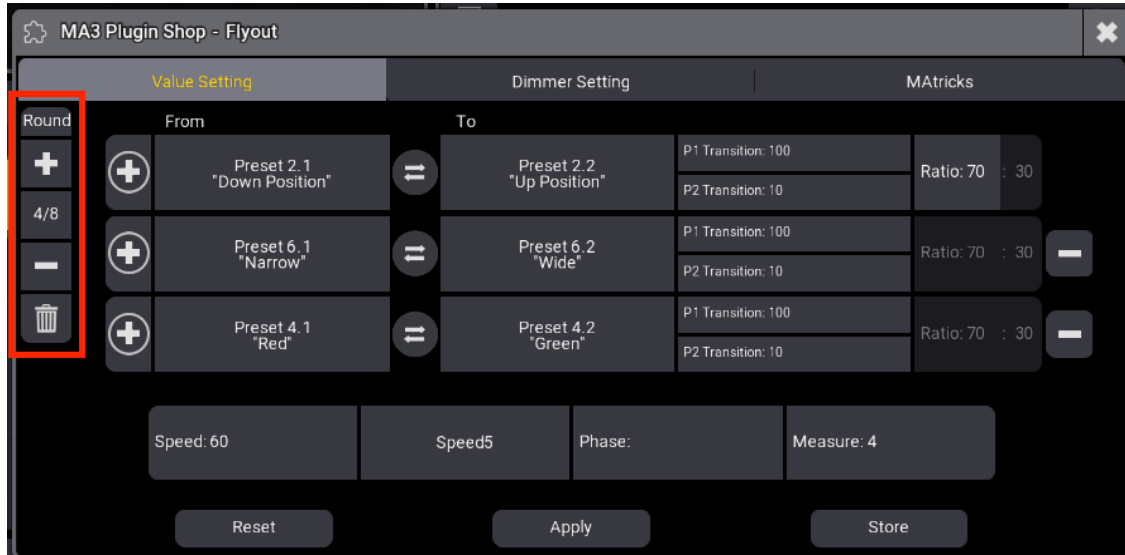

## Notes

Frequently changing the settings and re-entering the data in the phaser editor using the "Apply" buttons can cause the synchronization of the individual attributes to be lost.

This can be remedied by switching the Synchron button off and on again.

It can happen that after adding another attribute while the phaser is already running, the MAtricks entries have to be renewed so that all attributes are played out synchronously.

This is a normal behavior of the grandMA3 software and has nothing to do with this plug-in.

## **Known Limitation**

The use of "All presets" is only possible in preset slot 1.

Thank you for your attention and interest in our user manual.

We hope this manual has assisted you in making the desired settings.  
Should you have any further questions or require assistance,  
please do not hesitate to contact us at any time.

Contact

[ma3.plugin.shop@freenet.de](mailto:ma3.plugin.shop@freenet.de)